

# Connector Cables



## CID / CLD Series PRODUCT MANUAL

For your safety, read and follow the considerations written in the instruction manual, other manuals and Autonics website.

The specifications, dimensions, etc. are subject to change without notice for product improvement. Some models may be discontinued without notice.

### Features

- Connector cables for Autonics photoelectric sensors / proximity sensors / safety door switch / encoders
- Standard / L-shaped connector types available
- Available in various cable lengths

### Models

- Power supply of sensor and connector cable are should be same.

### ■ For photoelectric sensors / proximity sensors / safety door switch

Model	Power	Appearance	Connector	Cable spec.			Connections										
				Length (L)	Wire spec.	Material											
CID2-2	DC 2-wire	Socket I type	M12	2 m	AWG 22 (0.08 mm, 60-core), insulator diameter: Ø1.3 mm	PVC	<table border="1"> <thead> <tr> <th>Pin no.</th> <th>Wiring</th> </tr> </thead> <tbody> <tr> <td>1</td> <td></td> </tr> <tr> <td>2</td> <td></td> </tr> <tr> <td>3</td> <td>→ Blue</td> </tr> <tr> <td>4</td> <td>→ Brown</td> </tr> </tbody> </table>	Pin no.	Wiring	1		2		3	→ Blue	4	→ Brown
Pin no.				Wiring													
1																	
2																	
3		→ Blue															
4		→ Brown															
CID2-5		5 m															
CLD2-2		2 m															
CLD2-5	5 m																
CID2-2P	Plug I type	2 m															
CID2-5P		5 m															
CLD2-2P	Plug L type	2 m															
CLD2-5P		5 m															
CID2-2-I	DC 2-wire (IEC standard)	Socket I type	M12	2 m	AWG 22 (0.08 mm, 60-core), insulator diameter: Ø1.3 mm	PVC	<table border="1"> <thead> <tr> <th>Pin no.</th> <th>Wiring</th> </tr> </thead> <tbody> <tr> <td>1</td> <td>Brown</td> </tr> <tr> <td>2</td> <td>→ Blue</td> </tr> <tr> <td>4</td> <td></td> </tr> <tr> <td>3</td> <td></td> </tr> </tbody> </table>	Pin no.	Wiring	1	Brown	2	→ Blue	4		3	
Pin no.				Wiring													
1		Brown															
2		→ Blue															
4																	
3																	
CID2-5-I	5 m																
CLD2-2-I	Socket L type	2 m															
CLD2-5-I		5 m															
CID3-2	DC 3-wire	Socket I type	M12	2 m	AWG 22 (0.08 mm, 60-core), insulator diameter: Ø1.3 mm	PVC	<table border="1"> <thead> <tr> <th>Pin no.</th> <th>Wiring</th> </tr> </thead> <tbody> <tr> <td>1</td> <td>→ Brown</td> </tr> <tr> <td>2</td> <td></td> </tr> <tr> <td>3</td> <td>→ Blue</td> </tr> <tr> <td>4</td> <td>→ Black</td> </tr> </tbody> </table>	Pin no.	Wiring	1	→ Brown	2		3	→ Blue	4	→ Black
Pin no.				Wiring													
1		→ Brown															
2																	
3		→ Blue															
4		→ Black															
CID3-5	5 m																
CLD3-2	Socket L type	2 m															
CLD3-5		5 m															
CID3-2P	Plug I type	2 m															
CLD3-2P		2 m															
CID408-2	DC 4-wire	Socket I type	M8	2 m	AWG 22 (0.08 mm, 60-core), insulator diameter: Ø1.3 mm	PVC	<table border="1"> <thead> <tr> <th>Pin no.</th> <th>Wiring</th> </tr> </thead> <tbody> <tr> <td>1</td> <td>→ Brown</td> </tr> <tr> <td>2</td> <td>→ White</td> </tr> <tr> <td>3</td> <td>→ Blue</td> </tr> <tr> <td>4</td> <td>→ Black</td> </tr> </tbody> </table>	Pin no.	Wiring	1	→ Brown	2	→ White	3	→ Blue	4	→ Black
Pin no.				Wiring													
1		→ Brown															
2		→ White															
3	→ Blue																
4	→ Black																
CID408-5	5 m																
CLD408-2	Socket L type	2 m															
CLD408-5		5 m															
CIDH4-2	DC 4-wire	Socket I type	M12	2 m	AWG 22 (0.08 mm, 60-core), insulator diameter: Ø1.65 mm	Oil resistant PVC	<table border="1"> <thead> <tr> <th>Pin no.</th> <th>Wiring</th> </tr> </thead> <tbody> <tr> <td>1</td> <td>→ Brown</td> </tr> <tr> <td>2</td> <td>→ White</td> </tr> <tr> <td>3</td> <td>→ Blue</td> </tr> <tr> <td>4</td> <td>→ Black</td> </tr> </tbody> </table>	Pin no.	Wiring	1	→ Brown	2	→ White	3	→ Blue	4	→ Black
Pin no.				Wiring													
1				→ Brown													
2				→ White													
3		→ Blue															
4		→ Black															
CIDH4-3		3 m															
CIDH4-5		5 m															
CIDH4-7		7 m															
CLDH4-2		Socket L type		2 m													
CLDH4-3				3 m													
CLDH4-5				5 m													
CLDH4-7				7 m													
CIDH4-2P		Plug I type		2 m													
CIDH4-3P				3 m													
CIDH4-5P				5 m													
CIDH4-7P	7 m																
CLDH4-2P	Plug L type	2 m															
CLDH4-3P		3 m															
CLDH4-5P		5 m															
CLDH4-7P		7 m															
CIA2-2	AC 2-wire	Socket I type	M12	2 m	AWG 22 (0.08 mm, 60-core), insulator diameter: Ø1.3 mm	PVC	<table border="1"> <thead> <tr> <th>Pin no.</th> <th>Wiring</th> </tr> </thead> <tbody> <tr> <td>1</td> <td></td> </tr> <tr> <td>4</td> <td>→ Brown</td> </tr> <tr> <td>2</td> <td></td> </tr> <tr> <td>3</td> <td>→ Blue</td> </tr> </tbody> </table>	Pin no.	Wiring	1		4	→ Brown	2		3	→ Blue
Pin no.				Wiring													
1																	
4		→ Brown															
2																	
3		→ Blue															
CIA2-5		5 m															
CLA2-2		Socket L type		2 m													
CLA2-5				5 m													
CIA2-2P		Plug I type		2 m													
CIA2-5P				5 m													
CLA2-2P		Plug L type		2 m													
CLA2-5P				5 m													
CIAH2-2		Socket I type		M12	2 m	AWG 22 (0.08 mm, 60-core), insulator diameter: Ø1.65 mm		Oil resistant PVC									
CIAH2-5					5 m												
CLAH2-2					Socket L type				2 m								
CLAH2-5									5 m								
CIAH2-2P									Plug I type	2 m							
CIAH2-5P	5 m																
CLAH2-2P	Plug L type		2 m														
CLAH2-5P			5 m														

• Be careful of connection, because color is different when DC 4-wire connector cable is used for DC 2-wire sensor.

■ For encoders

Model	Power	Appearance	Cable length (L)	No. of pins	Connections																																
CID6S-2	DC	Socket I type	2 m	6-pin (Totem pole / NPN open collector / voltage output)	<table border="1"> <thead> <tr> <th>Pin no.</th> <th>Wiring</th> </tr> </thead> <tbody> <tr><td>1</td><td>Black</td></tr> <tr><td>2</td><td>White</td></tr> <tr><td>3</td><td>Orange</td></tr> <tr><td>4</td><td>Brown</td></tr> <tr><td>5</td><td>Blue</td></tr> <tr><td>6</td><td>Shield</td></tr> </tbody> </table>	Pin no.	Wiring	1	Black	2	White	3	Orange	4	Brown	5	Blue	6	Shield																		
Pin no.			Wiring																																		
1			Black																																		
2			White																																		
3			Orange																																		
4	Brown																																				
5	Blue																																				
6	Shield																																				
CID6S-5	5 m																																				
CID6S-10	10 m																																				
CID6S-15	15 m																																				
CID9S-2	DC	Socket I type	2 m	9-pin (Line driver output)	<table border="1"> <thead> <tr> <th>Pin no.</th> <th>Wiring</th> <th>Pin no.</th> <th>Wiring</th> </tr> </thead> <tbody> <tr><td>1</td><td>Black</td><td>6</td><td>Gray</td></tr> <tr><td>2</td><td>Red</td><td>7</td><td>Orange</td></tr> <tr><td>3</td><td>Brown</td><td>8</td><td>Yellow</td></tr> <tr><td>4</td><td>Blue</td><td>9</td><td>Shield</td></tr> <tr><td>5</td><td>White</td><td></td><td></td></tr> </tbody> </table>	Pin no.	Wiring	Pin no.	Wiring	1	Black	6	Gray	2	Red	7	Orange	3	Brown	8	Yellow	4	Blue	9	Shield	5	White										
Pin no.			Wiring			Pin no.	Wiring																														
1			Black			6	Gray																														
2	Red	7	Orange																																		
3	Brown	8	Yellow																																		
4	Blue	9	Shield																																		
5	White																																				
CID9S-5	5 m																																				
CID9S-10	10 m																																				
CID13S-2	DC	Socket I type	2 m	13-pin	<table border="1"> <thead> <tr> <th>Pin no.</th> <th>Wiring</th> <th>Pin no.</th> <th>Wiring</th> </tr> </thead> <tbody> <tr><td>1</td><td>Brown</td><td>8</td><td>White/Brown</td></tr> <tr><td>2</td><td>Red</td><td>9</td><td>White/Red</td></tr> <tr><td>3</td><td>Orange</td><td>10</td><td>White/Orange</td></tr> <tr><td>4</td><td>Yellow</td><td>11</td><td>Shield</td></tr> <tr><td>5</td><td>Blue</td><td>12</td><td>White</td></tr> <tr><td>6</td><td>Purple</td><td>13</td><td>Black</td></tr> <tr><td>7</td><td>Gray</td><td></td><td></td></tr> </tbody> </table>	Pin no.	Wiring	Pin no.	Wiring	1	Brown	8	White/Brown	2	Red	9	White/Red	3	Orange	10	White/Orange	4	Yellow	11	Shield	5	Blue	12	White	6	Purple	13	Black	7	Gray		
Pin no.			Wiring			Pin no.	Wiring																														
1			Brown			8	White/Brown																														
2	Red	9	White/Red																																		
3	Orange	10	White/Orange																																		
4	Yellow	11	Shield																																		
5	Blue	12	White																																		
6	Purple	13	Black																																		
7	Gray																																				
CID13S-5	5 m																																				
CID13S-10	10 m																																				

Dimensions

• Unit: mm, For the detailed drawings, follow the Autonics website.

■ For photoelectric sensors / proximity sensors / safety door switch

• Cable thickness is different by cable material.

Cable material	Cable thickness
PVC	∅5 mm
Oil resistant PVC	∅6 mm

• Socket I type (M12 connector)

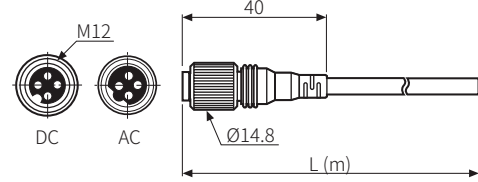

• Socket I type (M8 connector)

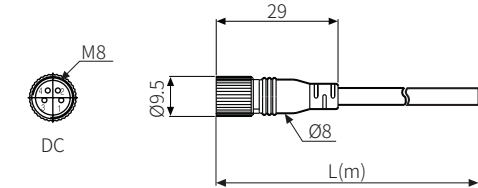

• Socket L type (M12 connector)

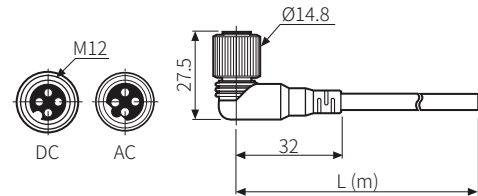

• Socket L type (M8 connector)

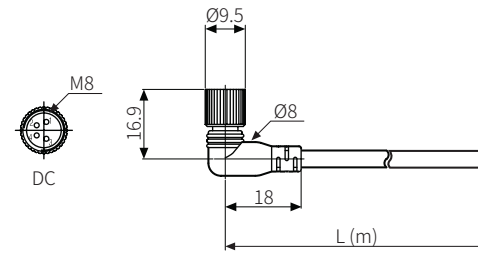

• Plug I type

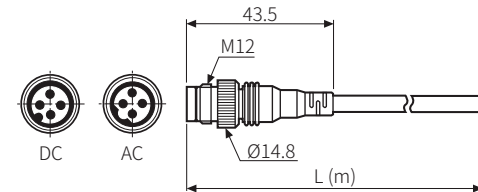

• Plug L type

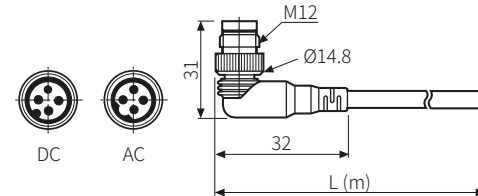

■ For encoders

- Connector cable: 6-pin

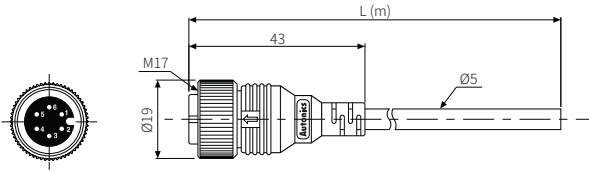

- Connector cable: 9-pin

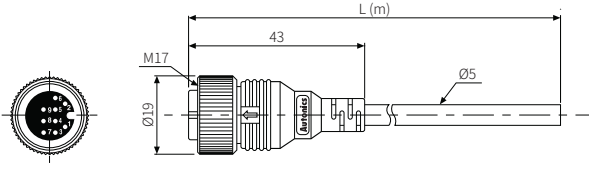

- Connector cable: 13-pin

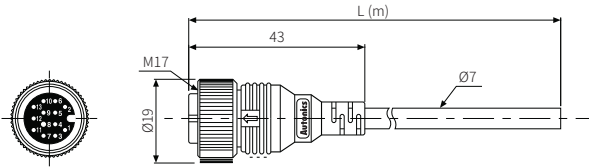

- Connector connection cable: 13-pin

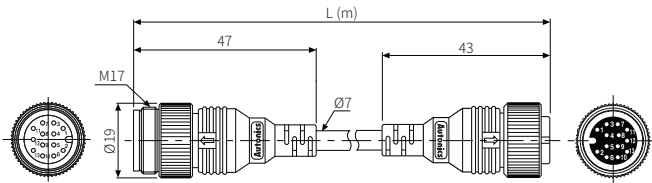

**Example of Connections**

■ Socket type

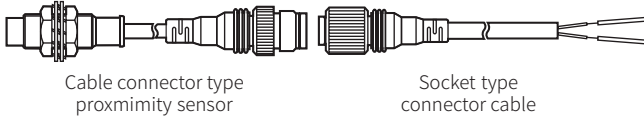

■ Plug type

